

# DMTT SERIES

## PROGRAMMABLE TILTING TABLE WITH FLAT FIXTURE PLATE

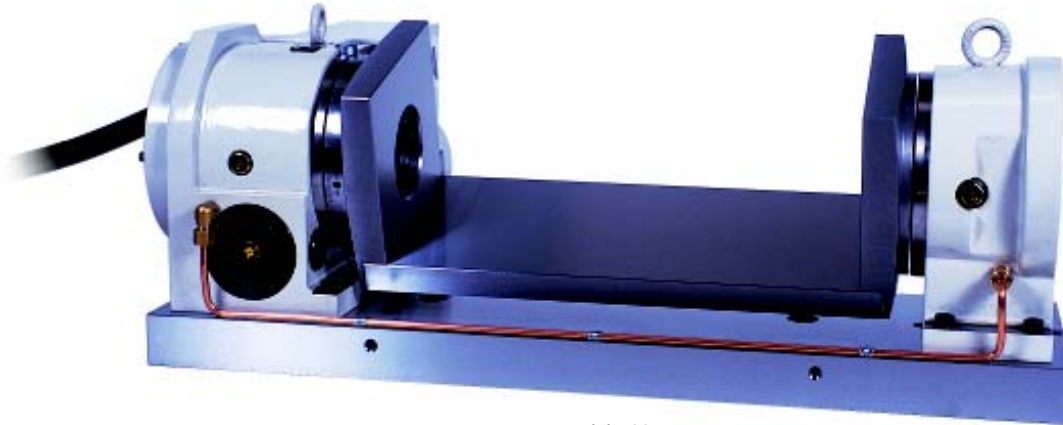

Model 522



UDNC-M1  
Controller



Heavy duty dual disc brake system

The DMTT models utilize the DMNC rotary table bodies for the "drive table." These tables are fixed on a mounting plate. A "full rotary" end support is mounted on the other end of the mounting plate. Both the rotary drive and end support sides are **ground together** at the factory to assure that the center height, parallelism, flatness, etc. are maintained. The end support is provided with **dual thrust roller bearings**, and a large spindle with the same thru hole as the rotary drive unit. A rectangular steel plate is bolted and located with fixture keys, to both the rotary and end support. This plate is easily removed however, so that a type of "Quick Change Plate effect" can be realized. The units also feature an "over-travel" system with built-in hard limit switches which can be set by the user to stop the tilting movement, in an O.T. situation.

Inch/(mm)

MODEL / DMTGF	4417	5522	6628
<b>BLOCK SIZE</b> (Square x Length)	15.75 x 3.94 (400 x 100)	19.69 x 5.12 (500 x 130)	23.62 x 5.91 (600 x 150)
<b>SPINDLE TORQUE</b> ft.lbs (Kg.m)	165 (23)	195 (27)	780 (108)
<b>MAX RPM</b>	55	45	22
<b>SPINDLE BRAKE TORQUE</b> ft.lbs (Kg.m)			
Pneumatic	220 (30)	360 (50)	650 (90)
Hydraulic	434 (60)	704 (98)	1030 (142)
<b>RESOLUTION (Degrees)</b>	0.000625"	0.0005"	0.00025"
<b>MAX LOAD CAPACITY</b> Vertical lbs. (Kg)	90 (41)	135 (61)	200 (91)
<b>TILTING ANGLE ACCURACY</b>	+/- 45 seconds		
<b>REPEATABILITY</b>	+/- 10 seconds		
<b>MOTOR TYPE</b>	Digital AC Servo		
<b>THRU HOLE DIA.</b>	1.77 (45)	2.50 (63.5)	3.54 (90)
<b>POWER SUPPLY</b>	105 ~ 240 VAC, 20 Amp, Single Phase		
<b>SPINDLE RUNOUT</b>	0.00006" (0.02mm)		
<b>CONTROLLER</b>	UDNC-M1		
<b>NET WEIGHT lbs (Kg)</b>	341 (155)	519 (236)	858 (390)

**CAN BE SUPPLIED AS FULL  
FOURTH AXIS.**

**ALL POPULAR MOTORS CAN  
BE ACCOMODATED.**

**HYDRAULIC SPINDLE BRAKES  
OPTIONAL.**

### EACH UNIT IS SUPPLIED WITH:

- ▶ UDNC-M1
- ▶ DMTT unit complete with rotary drive unit, end support and mounting plate complete
- ▶ Power cable (105~240 VAC, 20 amp, single phase)
- ▶ Remote cable for M-Code interface to CNC
- ▶ Operators manual, test report, warranty card and locating keys

## OVERALL DIMENSIONAL SPECIFICATIONS

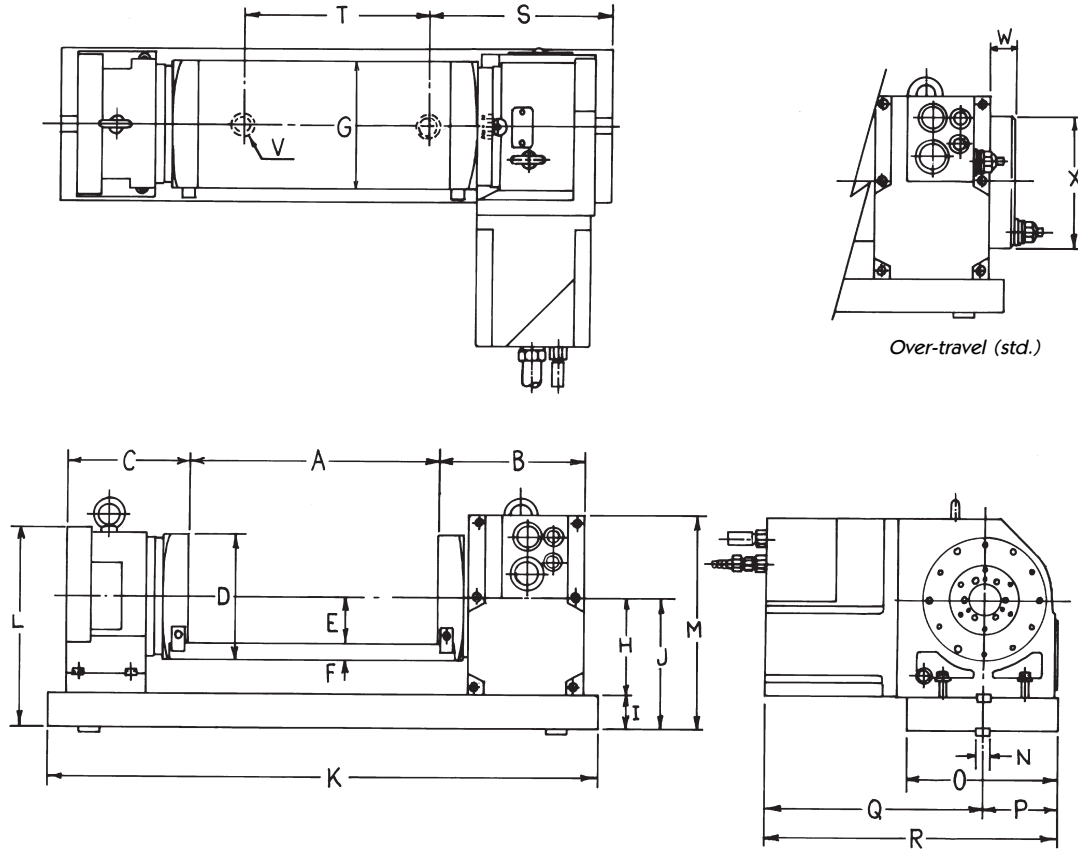

One of the main concerns to this type of fixture, is rigidity. The DMTT series, provides a large **dual disc braking mechanism on both the ROTARY DRIVE UNIT, AND THE END SUPPORT**. This unique design supplies maximum braking power over the entire machining area of the fixture plate, providing the rigidity required to machine even the toughest of materials. The units "one-piece" design makes mounting and removal to the machine table very easy. Locating keyways are machined on the underside of the mounting plate, making this operation very simple.

	Inch/(mm)												
MODEL	A	B	C	D	E	F	G	H	I	J	K	L	M
417	15.75 (400)	7.28 (185)	5.91 (150)	7.09 (180)	2.56 (65)	0.98 (25)	7.09 (180)	5.12 (130)	1.77 (45)	6.89 (175)	30.51 (775)	10.83 (275)	11.02 (280)
522	19.69 (500)	8.27 (210)	7.09 (180)	8.66 (220)	3.15 (80)	1.18 (30)	8.66 (220)	6.30 (160)	1.77 (45)	8.07 (205)	35.43 (900)	12.72 (323)	12.80 (325)
628	23.62 (600)	9.25 (235)	7.68 (195)	10.24 (260)	3.94 (100)	1.18 (30)	10.24 (260)	7.48 (190)	1.77 (45)	9.25 (235)	40.94 (1040)	15.08 (383)	15.16 (385)

	Inch/(mm)									
MODEL	N	O	P	Q	R	S	T	V	W	X
417	0.71 (18)	9.06 (230)	4.53 (115)	11.61 (295)	16.14 (410)	8.86 (225)	12.80 (325)	M-16	1.18 (30)	7.20 (183)
522	0.71 (18)	11.81 (300)	5.91 (150)	12.60 (320)	18.50 (470)	9.06 (230)	17.32 (440)	M-16	1.18 (30)	8.43 (214)
628	0.71 (18)	13.39 (340)	6.69 (170)	14.57 (370)	21.26 (540)	10.43 (265)	20.08 (510)	M-16	1.18 (30)	10.79 (274)

**END SUPPORTS MAY BE PURCHASED SEPARATELY.**

PART#	MODEL (Size)
SU-06170	(For 417 model)
SU-08170	(For 522 model)
SU-10170	(For 628 model)

Optional accessories are the same as for DMNC. Note: DMTT models can be supplied with fourth axis drives on request.

CNC ROTARY PRODUCTS